TECHNICAL INFORMATION

BlueView™ Gunpowder Particle Test Kit

Catalog No. BV100

INTRODUCTION

The BlueView™ Gunpowder Particle Test Kit is a fast, reliable field test for detection of trace nitrates found in gunpowder. When a weapon is fired gunpowder is blown back in the direction of the shooter and trace amounts of these residues are deposited on the shooter's firing hand. Detection of these trace residues can give valuable information regarding whether or not a particular person has recently fired a weapon. SIRCHIE® has developed this presumptive field test kit in a simple-to-use pouch format that can be deployed without any specialized training or equipment and results appear in seconds. This format will allow for presumptive on-the-spot testing at crime scenes or anywhere a suspect may be apprehended.



CAUTIONS

- Before using this product, consult the appropriate Material Safety Data Sheets (MSDS) found on our website at www.sirchie.com/support.
- **WARNING:** Reagent contains sulfuric acid. May be harmful or fatal if swallowed. Avoid direct contact.

FIRST AID

For eye contact, flush with water thoroughly for 15 minutes and seek medical attention. If swallowed, do not induce vomiting—rinse mouth and give 1-2 glasses of water. Seek medical attention.

PROCEDURE

WARNING: BlueView™ is a presumptive screening test and may interfere with, or compromise, further testing using Atomic Absorption Analysis (AAA) or Scanning Electron Microscopy (SEM) testing.

1. Unclip pouch and remove the Gunpowder Particle Collection Lifter.
2. Hold the lifter by the tab. Open the Collection Lifter and expose the adhesive surface by peeling back and discarding the protective cover. Peel back from the scored line.
3. **FOR HANDGUN PARTICLE COLLECTION**—place the adhesive side of the Gunpowder Particle Collection Lifter in direct contact with the back and palm surfaces of both hands (especially the webs of both hands). Place, press and lift the Collection Lifter several times over these locations (see Fig. 1).

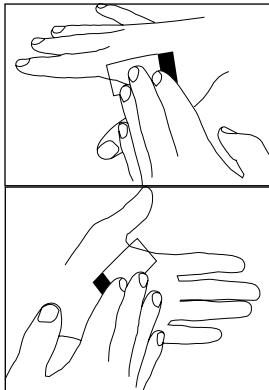

FIGURE 1

FOR RIFLE AND SEMI-AUTOMATIC GUN PARTICLE COLLECTION— place the adhesive side of the lifter in direct contact with the back and palm surfaces of both hands (especially the webs of both hands), against both cheeks of the face and against both sides of the shoulder/chest area of the subject's clothing. Place, press and lift the Collection Lifter several times over these locations (see Figs. 1-2).

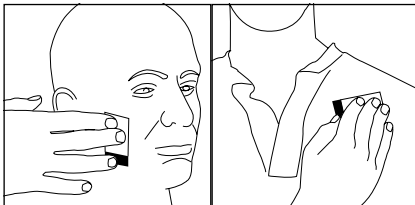

FIGURE 2

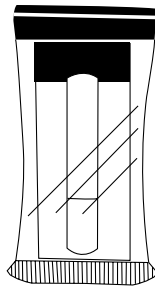

FIGURE 3

4. Remove the Crushable Reagent Ampoule from the pouch. Place the ampoule in the center of the adhesive side of the Collection Lifter and return to pouch. Fold back the top of pouch and replace the clip (see Fig. 3).
5. Squeeze the crushable ampoule between your forefinger and thumb until ampoule breaks.
6. Shake the pouch well to wet surface of the Collection Lifter.
7. If gunpowder particles are present, blue specks and/or smears will be observed against the white background within 3-6 minutes. Finer particles may be observed with the straight handle magnifier.
8. Observed results may vary depending on temperature. Best results are obtained between 70-90 degrees Fahrenheit. Lower temperatures will slow the results.

BV100 Contents:

(10) Crushable Ampoules; (10) Gunpowder Particle Collection Lifters; and (1) Straight Handle Magnifier.

SIRCHIE®



100 HUNTER PLACE, YOUNGSVILLE, NC 27596 USA

919-554-2244 • 800-356-7311

www.sirchie.com